

**[KS]**

**※SPECIFICATION**

Model	Size	Max. Pres. MPa(PSI)	Max. Flow ℓ/min(GPM)	Filtration (μm)	Weight (Kg)
KS	08	21 (3050)	20(6.0)	25	0.4
	10		40(11.8)		0.6
	12		80(21.1)		0.9

**※GRAPHIC SYMBOL**

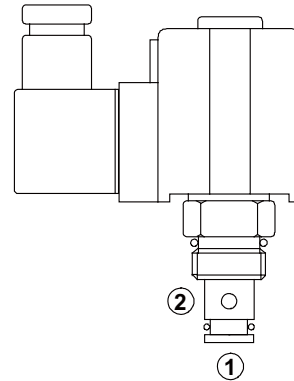
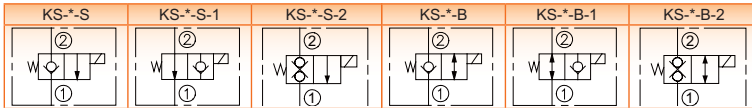

**※MODEL NUMBER DESIGNATION**

KS-	(T)-	08-	B-	(1)-	(M)-	D24-	10		
							KS	KST(KSMT)	KSG(KSMG)
<b>Series No.</b>	Valve Housing Omit: Without Valve Housing T: Valve with In-Line Housing G: Valve with Gasket Housing	<b>Valve Size</b> 08 10 12	<b>Flow Direction</b> S: Single Direction ② → ① B: Two-Way Direction ② ↔ ①	<b>Action</b> Omit: Normally Closed 1: Normally Open 2: Bidirectional Blocking	Omit: Without Manual Override M: With Manual Override	<b>Voltage</b> A15: AC 110V/50HZ A16: AC 110V/60HZ A24: AC 240V/50HZ A25: AC 220V/50HZ A26: AC 220V/60HZ D12: DC 12V D24: DC 24V R110: RF 110V/50HZ (Rectified) R220: RF 220V/50HZ (Rectified)	<b>Design No.</b>	<b>Thread Connection</b> 10: PT(Rc) 80: PF(G) 90: NPT	<b>Mounting Bolts</b> 10: With DIN 912 Bolts 90: With UNC Bolts (North American Std.)

★ The item with "( )" may be omitted.

**※DIMENSIONS & CAVITIES**

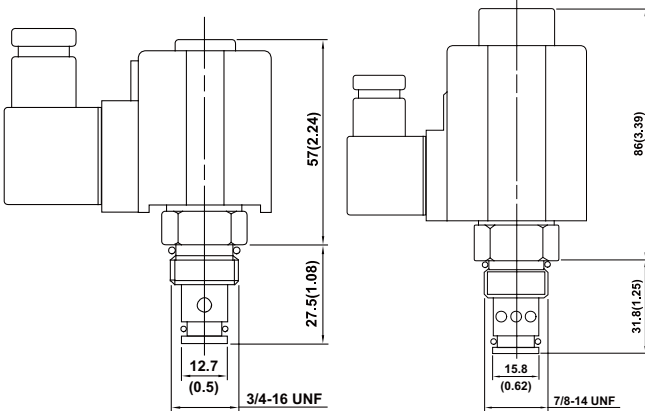

**KS-08**

**KS-10**

- 1.188 Dia. Spotface x .031 Deep #
- 0.502/0.500 Dia. x 1.156 Deep \*
- 0.690/0.686 Dia. x 0.750 Deep \*
- 3/4 - 16UNF - 2B x 0.500 Deep \*

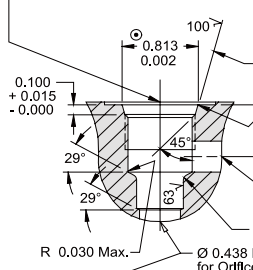

Note:  
Cavity Variation "A" \*\*  
Min. Pilot Drill Ø 0.438 Req. to  
Min. Depth of 1.81 from Spotface

- 1.188 Dia. Spotface x .031 Deep #
- 0.627/0.625 Dia. x 1.312 Deep \*
- 0.814/0.810 Dia. x 0.932 Deep \*
- 7/8 - 14UNF - 2B x 0.625 Deep \*

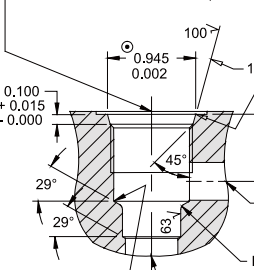

Note:  
Cavity Variation "A" \*\*  
Min. Pilot Drill Ø 0.562 Req. to  
Min. Depth of 1.50 from Spotface

**REMARK:**

The pressure forming port must be in ② port, otherwise the manual device will not be able to effect.

**KS-12**

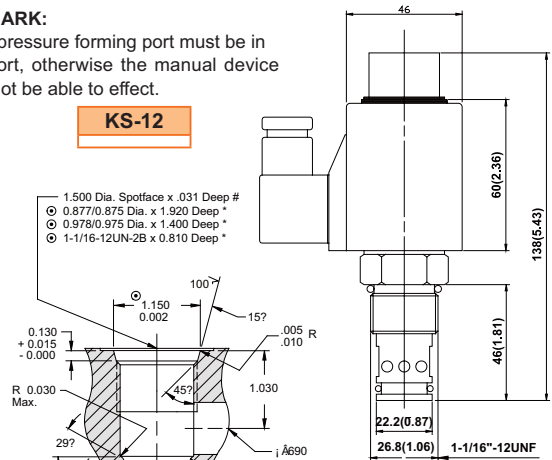

Note:  
Cavity Variation "A" \*\*  
Min. Pilot Drill Ø 0.75 Req. to  
Min. Depth of 2.14 from Spotface

Note:  
Cavity Variation "B" \*\*  
Pilot Drill Ø 0.812 Req. to  
Min. Depth of 2.45 from Spotface

The above features (except for pilot drill & cross drills) can be machined simultaneously with a form tool.

- ⊙ -- These diameters to be concentric within 0.002 T.I.R. and perpendicular to spotface within 0.001 T.I.R.
- \* -- Depths are from spotface.
- # -- Unless otherwise specified on machining drawing
- Unspecified tolerances are 0.005.
- \*\* -- Features of Variation "A" are required only if noted on specific product catalog page.

UNIT: M.M.(INCH)

### VALVE HOUSINGS

#### KSMT-08-10

In-Line Housing

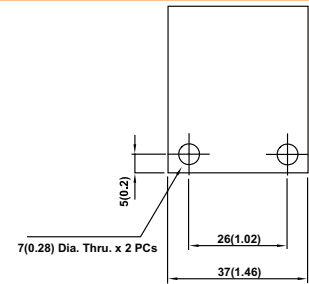
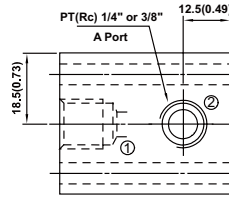
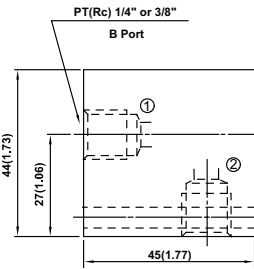
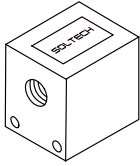

#### KSMT-10-10

In-Line Housing

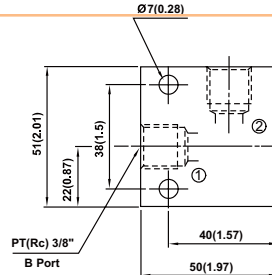
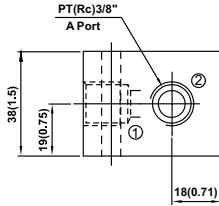
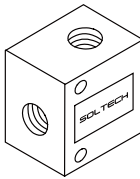

#### KSMT-12-10

In-Line Housing

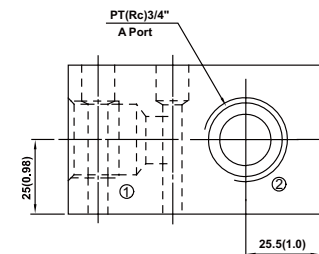
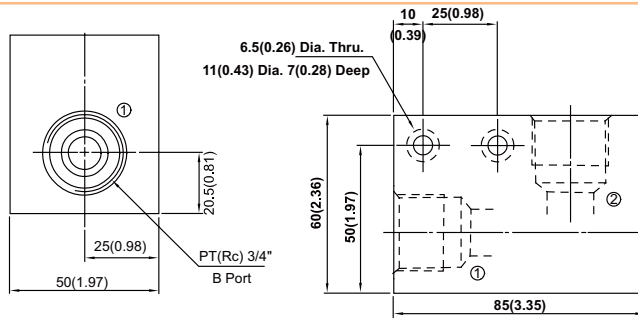
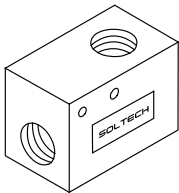

#### KSMG-08

Gasket Housing

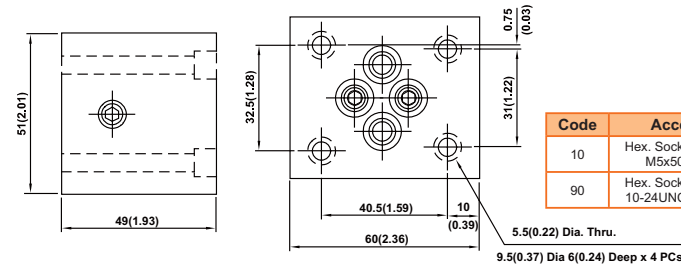
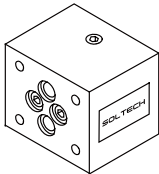

Code	Accessories	Additional Code	Function Port
10	Hex. Socket Head Screw M5x50Lg x 4 PCs	PT	P → T
		PA	P → A
90	Hex. Socket Head Screw 10-24UNCx2\"Lg x 4 PCs	PB	P → B
		AB	A → B
		AT	A → T
		BT	B → T

#### KSMG-10

Gasket Housing

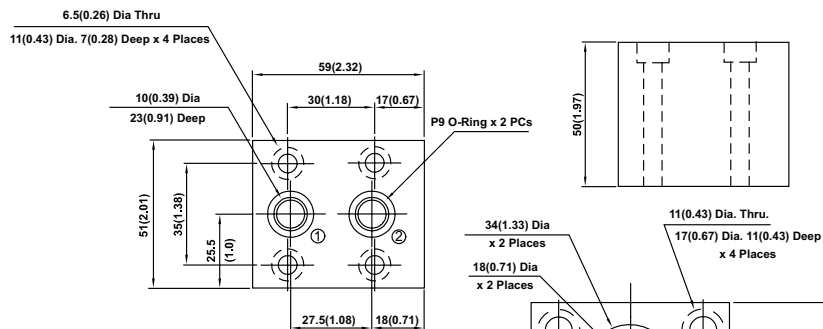
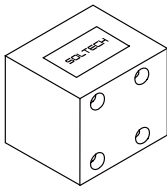

Code	Accessories
10	Hex. Socket Head Screw M6x55Lg x 4 PCs
90	Hex. Socket Head Screw 1/4-20UNCx2-1/8\"Lg x 4 PCs

#### KSMG-12

Gasket Housing

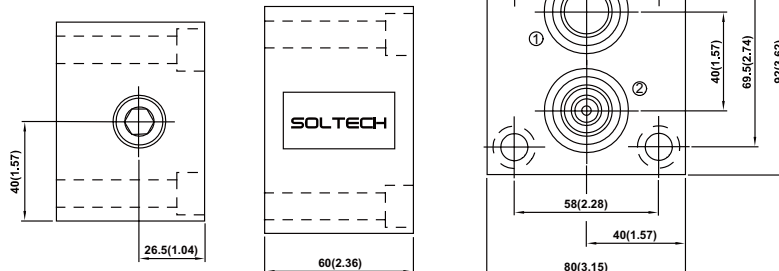
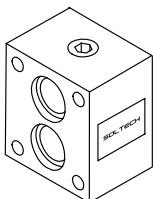

Code	Accessories
10	Hex. Socket Head Screw M10x65Lg x 4 PCs
90	Hex. Socket Head Screw 3/8-16UNCx2-5/8\"Lg x 4 PCs